

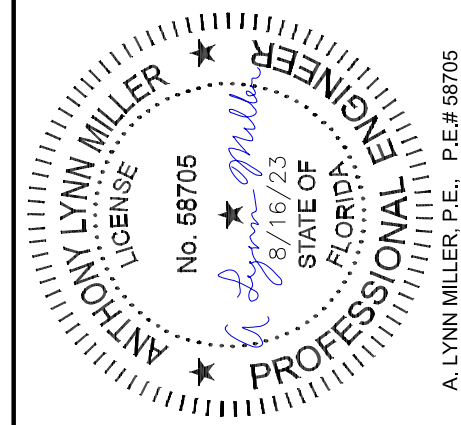

MODEL 1860 FIXED PICTURE WINDOW,
NON-IMPACT RESISTANT,
EQUAL-LEG, INTEGRAL FIN AND FIN/FLANGE FRAMES

FLORIDA PRODUCT APPROVAL #39123

DP RATING	NOT RATED FOR IMPACT RESISTANCE
SEE TABLES A-E	



1) THIS PRODUCT HAS BEEN DESIGNED & TESTED TO COMPLY WITH THE REQUIREMENTS OF THE FLORIDA BUILDING CODE, EXCLUDING THE HIGH VELOCITY HURRICANE ZONE (HVHZ).

2) SHUTTERS ARE REQUIRED WHEN USED IN WIND-BORNE DEBRIS REGIONS.

3) MASONRY ANCHORS MAY BE USED INTO WOOD. ALL WOOD BUCKS LESS THAN 1-1/2" THICK ARE TO BE CONSIDERED 1X INSTALLATIONS. 1X WOOD BUCKS ARE OPTIONAL IF UNIT IS INSTALLED DIRECTLY TO SUBSTRATE. WOOD BUCKS DEPICTED AS 2X ARE 1-1/2" THICK OR GREATER.

4) ANCHOR EMBEDMENT TO BASE MATERIAL SHALL BE BEYOND WALL DRESSING OR STUCCO. USE ANCHORS OF SUFFICIENT LENGTH.

5) MAX. 1/4" SHIMS ARE REQUIRED AT EACH ANCHOR LOCATION WHERE THE PRODUCT IS NOT FLUSH TO THE SUBSTRATE. USE SHIMS CAPABLE OF TRANSFERRING APPLIED LOADS.

6) THE ANCHORAGE METHODS SHOWN HAVE BEEN DESIGNED TO RESIST THE WIND LOADS CORRESPONDING TO THE REQUIRED DESIGN PRESSURE. THE 33-1/3% STRESS INCREASE HAS NOT BEEN USED IN THE DESIGN OF THIS PRODUCT. THE 1.6 LOAD DURATION FACTOR WAS USED FOR THE EVALUATION OF ANCHORS INTO WOOD. ANCHORS THAT COME INTO CONTACT WITH OTHER DISSIMILAR MATERIALS SHALL MEET THE REQUIREMENTS OF THE FLORIDA BUILDING CODE FOR CORROSION RESISTANCE.

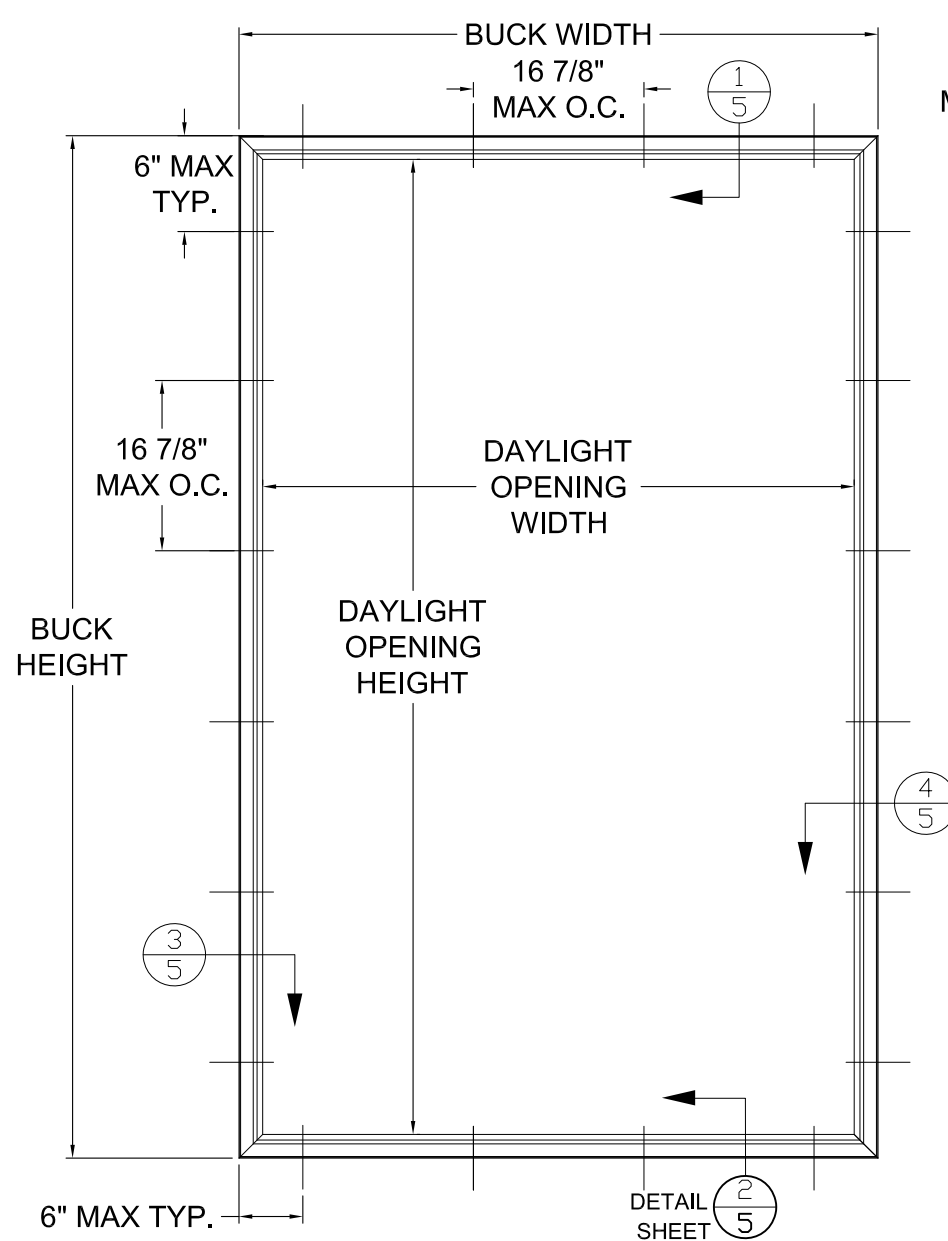

TYP. ANCHOR LOCATIONS
(EQUAL-LEG FRAME)
SEE TABLES A-E FOR SIZES

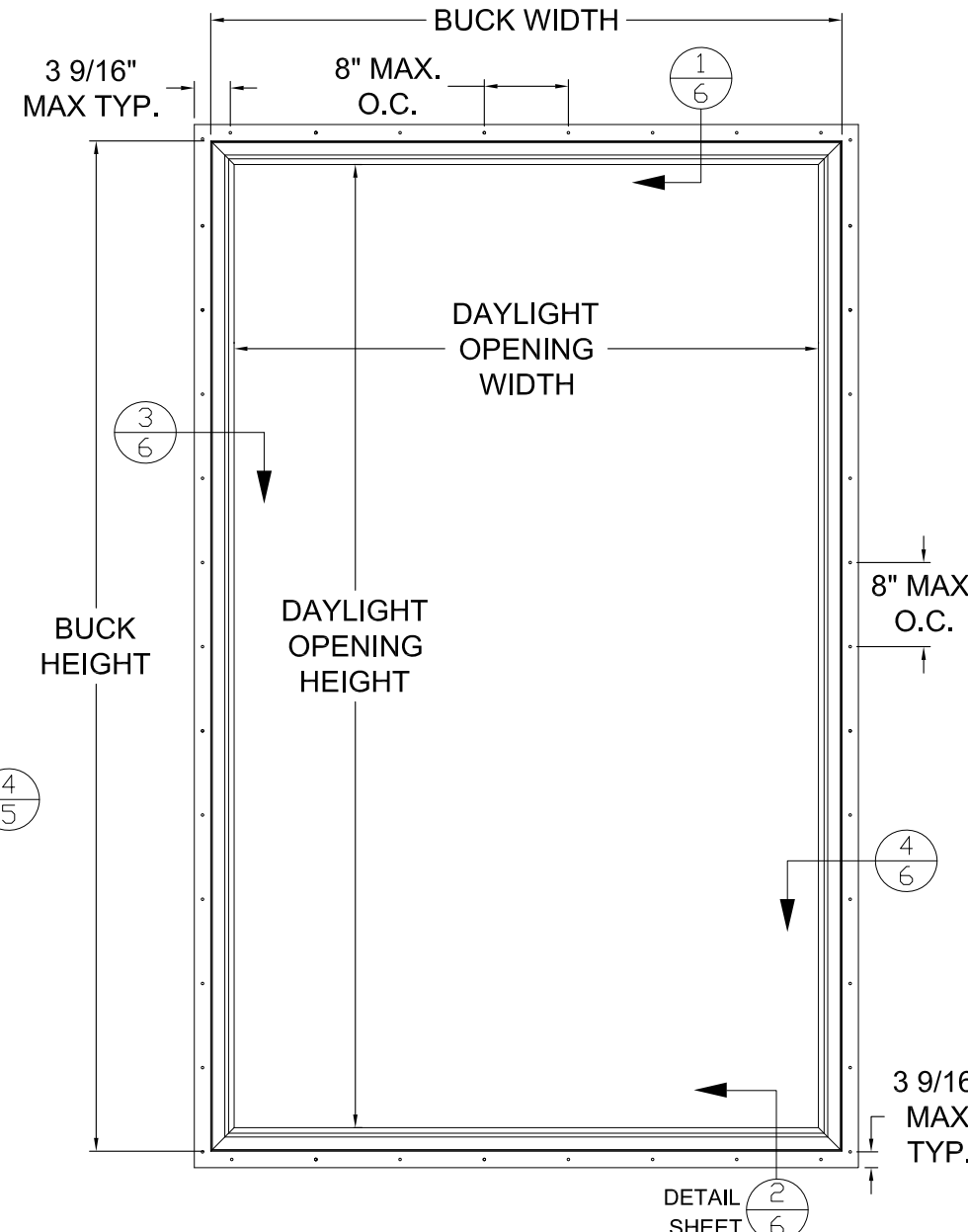

TYP. ANCHOR LOCATIONS
(INTEGRAL FIN AND FIN/FLANGE FRAME)
SEE TABLES A-E FOR SIZES

DAYLIGHT OPENING WIDTH = BUCK WIDTH - 4.4375
DAYLIGHT OPENING HEIGHT = BUCK HEIGHT - 4.4375

REGISTRATION #29296	COPYRIGHT © 2022 NEWSOUTH WINDOW SOLUTIONS LIMITED LICENSE TO MAKE COPIES FOR PERMITTING	
PREPARED BY: A. LYNN MILLER, P.E. 1070 TECHNOLOGY DR N. VENICE, FL 34275 (941)-480-1600	1860 SERIES PICTURE WINDOW GENERAL NOTES & ANCHOR ELEVATION NEWSOUTH WINDOW SOLUTIONS 10741 CROSSROADS COMMERCE BLVD. TAMPA, FL 33610	
BY: SB	REVISION:	ADD SILICONE 995
DATE: 08/16/23	#:	A
DATE: 8/12/22	SCALE: NTS	
BY: S. Berkowitz		
DRAWING #: PW1860-FPA-01		
SHEET: 1 OF 8		

TABLE A:

		Window Design Pressure (psf)																			
		Glass Type 1: 7/8" IG (1/8" A - AIRSPACE - 1/8" A)																			
		Long Side (in.)																			
		51.5	54	56	58	60	62	64	66	68	70	72	74	76	78	80	82	84	86		
Short Side (in.)	18	+/-50	+/-50	+/-50	+/-50	+/-50	+/-50	+/-50	+/-50	+/-50	+/-50	+/-50	+/-50	+/-50	+/-50	+/-50	+/-50	+/-50	+/-50		
	20	+/-50	+/-50	+/-50	+/-50	+/-50	+/-50	+/-50	+/-50	+/-50	+/-50	+/-50	+/-50	+/-50	+/-50	+/-50	+/-50	+/-50	+/-50		
	22	+/-50	+/-50	+/-50	+/-50	+/-50	+/-50	+/-50	+/-50	+/-50	+/-50	+/-50	+/-50	+/-50	+/-50	+/-50	+/-50	+/-50	+/-50		
	24	+/-50	+/-50	+/-50	+/-50	+/-50	+/-50	+/-50	+/-50	+/-50	+/-50	+/-50	+/-50	+/-50	+/-50	+/-50	+/-50	+/-50	+/-50		
	26	+/-50	+/-50	+/-50	+/-50	+/-50	+/-50	+/-50	+/-50	+/-50	+/-50	+/-50	+/-49.3	+/-47.9	+/-46.9	+/-45.9	+/-45.1	+/-44.5	+/-43.8	+/-43.2	
	28	+/-50	+/-50	+/-50	+/-50	+/-50	+/-50	+/-50	+/-50	+/-50	+/-50	+/-50	+/-47.9	+/-46.3	+/-45	+/-43.7	+/-42.5	+/-41.3	+/-40.3	+/-39.3	+/-38.4
	30	+/-50	+/-50	+/-50	+/-50	+/-50	+/-50	+/-50	+/-50	+/-50	+/-50	+/-50	+/-47.6	+/-45.8	+/-44.2	+/-42.6	+/-41	+/-39.5	+/-38	+/-36.9	+/-36.2
	32	+/-50	+/-50	+/-50	+/-50	+/-50	+/-50	+/-50	+/-50	+/-50	+/-50	+/-50	+/-48.3	+/-46.2	+/-44.4	+/-42.8	+/-41	+/-39.2	+/-37.6		
	34	+/-50	+/-50	+/-50	+/-50	+/-50	+/-50	+/-50	+/-50	+/-50	+/-50	+/-50	+/-48.9	+/-46.8	+/-45.1	+/-43.5	+/-41.7				
	36	+/-50	+/-50	+/-50	+/-50	+/-50	+/-50	+/-50	+/-50	+/-50	+/-50	+/-50	+/-49.3	+/-47.1							
	38	+/-50	+/-50	+/-50	+/-50	+/-50	+/-50	+/-50	+/-50	+/-50	+/-50	+/-50									
	40	+/-50	+/-50	+/-50	+/-50	+/-50	+/-50	+/-50	+/-50	+/-50	+/-50										
	42	+/-50	+/-50	+/-50	+/-50	+/-50	+/-50														
	44	+/-50	+/-50	+/-50	+/-50	+/-50															
	46	+/-50	+/-50	+/-50																	
	48	+/-50	+/-50																		
51.5	+/-50																				

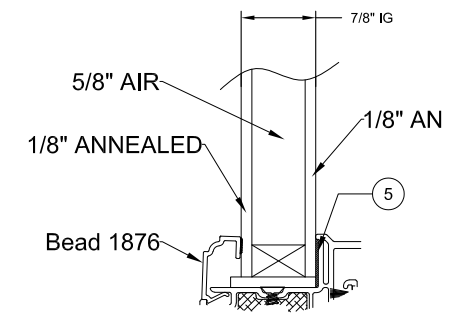

GLASS TYPE 1
7/8"IG (1/8" A- 5/8" Air -1/8" A)

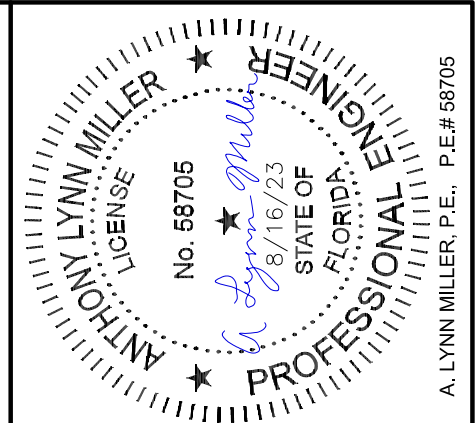

A. LYNN MILLER, P.E., P.E.# 58705

TABLE B:

		Window Design Pressure (psf)																			
		Glass Type 2: 7/8" IG (1/8" T - AIRSPACE - 1/8" T)																			
		Long Side (in.)																			
		61.625	64	66	68	70	72	74	76	78	80	82	84	86	88	90	92	94	96	98	
Short Side (in.)	24	+/-50	+/-50	+/-50	+/-50	+/-50	+/-50	+/-50	+/-50	+/-50	+/-50	+/-50	+/-50	+/-50	+/-50	+/-50	+/-50	+/-50	+/-50	+/-50	
	26	+/-50	+/-50	+/-50	+/-50	+/-50	+/-50	+/-50	+/-50	+/-50	+/-50	+/-50	+/-50	+/-50	+/-50	+/-50	+/-50	+/-50	+/-50	+/-50	+/-50
	28	+/-50	+/-50	+/-50	+/-50	+/-50	+/-50	+/-50	+/-50	+/-50	+/-50	+/-50	+/-50	+/-50	+/-50	+/-50	+/-50	+/-50	+/-50	+/-50	+/-50
	30	+/-50	+/-50	+/-50	+/-50	+/-50	+/-50	+/-50	+/-50	+/-50	+/-50	+/-50	+/-50	+/-50	+/-50	+/-50	+/-50	+/-50	+/-50	+/-50	+/-50
	32	+/-50	+/-50	+/-50	+/-50	+/-50	+/-50	+/-50	+/-50	+/-50	+/-50	+/-50	+/-50	+/-50	+/-50	+/-50	+/-50	+/-50	+/-50	+/-50	+/-50
	34	+/-50	+/-50	+/-50	+/-50	+/-50	+/-50	+/-50	+/-50	+/-50	+/-50	+/-50	+/-50	+/-50	+/-50	+/-50	+/-50	+/-50	+/-50	+/-50	+/-50
	36	+/-50	+/-50	+/-50	+/-50	+/-50	+/-50	+/-50	+/-50	+/-50	+/-50	+/-50	+/-50	+/-50	+/-50	+/-50	+/-50	+/-50	+/-50	+/-50	+/-50
	38	+/-50	+/-50	+/-50	+/-50	+/-50	+/-50	+/-50	+/-50	+/-50	+/-50	+/-50	+/-50	+/-50	+/-50	+/-50	+/-50	+/-50	+/-50	+/-50	+/-50
	40	+/-50	+/-50	+/-50	+/-50	+/-50	+/-50	+/-50	+/-50	+/-50	+/-50	+/-50	+/-50	+/-50	+/-50	+/-50	+/-50	+/-50	+/-50	+/-50	+/-50
	42	+/-50	+/-50	+/-50	+/-50	+/-50	+/-50	+/-50	+/-50	+/-50	+/-50	+/-50	+/-50	+/-50	+/-50	+/-50	+/-50	+/-50	+/-50	+/-50	+/-50
	44	+/-50	+/-50	+/-50	+/-50	+/-50	+/-50	+/-50	+/-50	+/-50	+/-50	+/-50	+/-50	+/-50	+/-50	+/-50	+/-50	+/-50	+/-50	+/-50	+/-50
	46	+/-50	+/-50	+/-50	+/-50	+/-50	+/-50	+/-50	+/-50	+/-50	+/-50	+/-50	+/-50	+/-50	+/-50	+/-50	+/-50	+/-50	+/-50	+/-50	+/-50
	48	+/-50	+/-50	+/-50	+/-50	+/-50	+/-50	+/-50	+/-50	+/-50	+/-50	+/-50	+/-50	+/-50	+/-50	+/-50	+/-50	+/-50	+/-50	+/-50	+/-50
	50	+/-50	+/-50	+/-50	+/-50	+/-50	+/-50	+/-50	+/-50												
	52	+/-50	+/-50	+/-50	+/-50	+/-50	+/-50														
	54	+/-50	+/-50	+/-50	+/-50	+/-50															
56	+/-50	+/-50	+/-50																		
58	+/-50	+/-50																			
61.625	+/-50																				

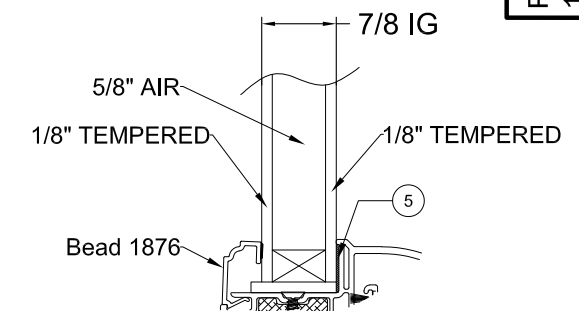

GLASS TYPE 2
7/8"IG (1/8" T -5/8" Air -1/8" T)

REGISTRATION #29296
COPYRIGHT © 2022
NEWSOUTH WINDOW SOLUTIONS
LIMITED LICENSE TO MAKE
COPIES FOR PERMITTING

PREPARED BY: A. LYNN MILLER, P.E.
1070 TECHNOLOGY DR
N. VENICE, FL 34275
(941)-480-1600

1860 SERIES PICTURE WINDOW	DP AND GLASS TYPES	NEWSOUTH WINDOW SOLUTIONS 10741 CROSSROADS COMMERCE BLVD. TAMPA, FL 33610
BY: SB	REVISION: ADD SILICONE 995	DATE: 08/16/23
#: A	DATE: 8/12/22	SCALE: NTS
	BY: S. Berkowitz	DRAWING #: PW1860-FPA-01
		SHEET: 2 OF 8

NOTE: 1) FOR SIZES NOT SHOWN, ROUND UP TO THE NEXT AVAILABLE WIDTH OR HEIGHT DIMENSION.

TABLE C:

		Window Design Pressure (psf)														
		Glass Type 3: 7/8" IG (3/16" A - AIRSPACE - 3/16" A)														
		Long Side (in.)														
		70.3125	72	74	76	78	80	82	84	86	88	90	92	94	96	98
Short Side (in.)	42	+/-50	+/-50	+/-50	+/-50	+/-50	+/-50	+/-50	+/-50	+/-50	+/-50	+/-50	+/-49.6	+/-47.8	+/-46.4	+/-45.3
	44	+/-50	+/-50	+/-50	+/-50	+/-50	+/-50	+/-50	+/-50	+/-50	+/-50	+/-50	+/-49.8	+/-48.1	+/-46.5	+/-45.3
	46	+/-50	+/-50	+/-50	+/-50	+/-50	+/-50	+/-50	+/-50	+/-50	+/-50	+/-50	+/-49.9	+/-48.2	+/-46.7	+/-45.5
	48	+/-50	+/-50	+/-50	+/-50	+/-50	+/-50	+/-50	+/-50	+/-50	+/-50	+/-50	+/-49.9	+/-48.2	+/-46.8	+/-45.7
	50	+/-50	+/-50	+/-50	+/-50	+/-50	+/-50	+/-50	+/-50	+/-50	+/-50	+/-50	+/-49.8	+/-48.2	+/-46.7	+/-45.6
	52	+/-50	+/-50	+/-50	+/-50	+/-50	+/-50	+/-50	+/-50	+/-50	+/-50	+/-50	+/-49.6	+/-48.1		
	54	+/-50	+/-50	+/-50	+/-50	+/-50	+/-50	+/-50	+/-50	+/-50	+/-50	+/-50	+/-49.9			
	56	+/-50	+/-50	+/-50	+/-50	+/-50	+/-50	+/-50	+/-50	+/-50	+/-50	+/-50				
	58	+/-50	+/-50	+/-50	+/-50	+/-50	+/-50	+/-50	+/-50	+/-50						
	60	+/-50	+/-50	+/-50	+/-50	+/-50	+/-50	+/-50								
	62	+/-50	+/-50	+/-50	+/-50	+/-50										
	64	+/-50	+/-50	+/-50	+/-50											
	66	+/-50	+/-50	+/-50												
	68	+/-50	+/-50													
70.3125	+/-50															

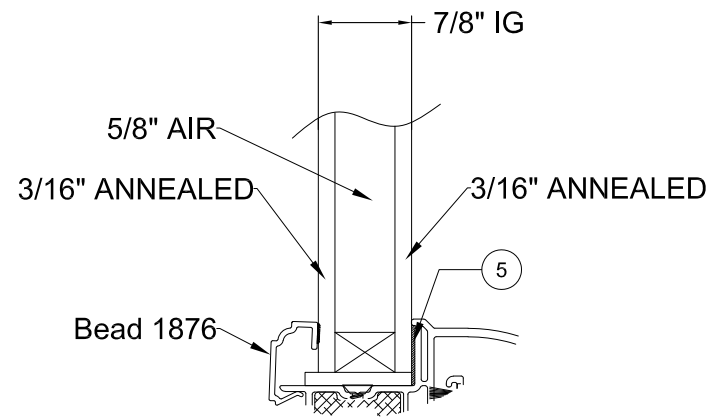

GLASS TYPE 3
7/8"IG (3/16" A -1/2" Air -3/16" A)

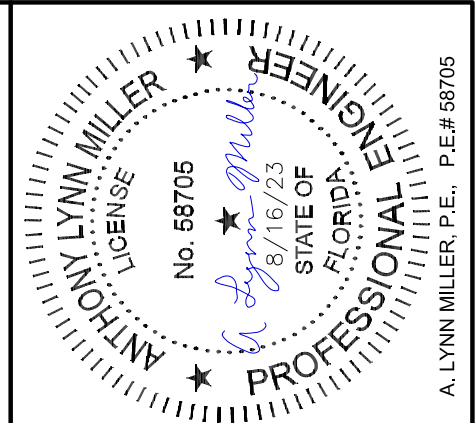

REGISTRATION #29296
 PREPARED BY: A. LYNN MILLER, P.E.
 1070 TECHNOLOGY DR
 N. VENICE, FL 34275
 (941)-480-1600

COPYRIGHT © 2022
 NEWSOUTH WINDOW SOLUTIONS
 LIMITED LICENSE TO MAKE
 COPIES FOR PERMITTING

1860 SERIES PICTURE WINDOW
 DP TABLES & GLASS TYPES
 NEWSOUTH WINDOW SOLUTIONS
 10741 CROSSROADS COMMERCE BLVD.
 TAMPA, FL 33610

REVISION:	BY:	SB
DATE:	08/16/23	
#:	A	
DATE:	8/12/22	
SCALE:	NTS	
BY:	S. Berkowitz	
DRAWING #:	PW1860-FPA-01	
SHEET:	3 OF 8	

NOTE: 1) FOR SIZES NOT SHOWN, ROUND UP TO THE NEXT AVAILABLE WIDTH OR HEIGHT DIMENSION.

TABLE D:

Window Design Pressure (psf)																									
Glass Type 5: 1" IG (1/4" A - AIRSPACE - 1/4" A)																									
		Long Side (in.)																							
		75.875	78	80	82	84	86	88	90	92	94	96	98	100	102	104	106	108	110	112	114	116	118	120	
Short Side (in.)	44	+/-50	+/-50	+/-50	+/-50	+/-50	+/-50	+/-50	+/-50	+/-50	+/-50	+/-50	+/-50	+/-50	+/-50	+/-50	+/-50	+/-50	+/-49.8	+/-48.8	+/-47.9	+/-47.2	+/-46.6	+/-45.9	
	46	+/-50	+/-50	+/-50	+/-50	+/-50	+/-50	+/-50	+/-50	+/-50	+/-50	+/-50	+/-50	+/-50	+/-50	+/-50	+/-50	+/-50	+/-48.7	+/-47.5	+/-46.6	+/-45.9	+/-45.3	+/-44.6	+/-43.9
	48	+/-50	+/-50	+/-50	+/-50	+/-50	+/-50	+/-50	+/-50	+/-50	+/-50	+/-50	+/-50	+/-50	+/-50	+/-50	+/-50	+/-49	+/-47.7	+/-46.6	+/-45.7	+/-44.7	+/-43.9	+/-43.2	+/-42.4
	50	+/-50	+/-50	+/-50	+/-50	+/-50	+/-50	+/-50	+/-50	+/-50	+/-50	+/-50	+/-50	+/-50	+/-50	+/-50	+/-50	+/-48.6	+/-47.1	+/-46.2	+/-45.3	+/-44.3			
	52	+/-50	+/-50	+/-50	+/-50	+/-50	+/-50	+/-50	+/-50	+/-50	+/-50	+/-50	+/-50	+/-50	+/-50	+/-50	+/-50	+/-48.6	+/-47.2	+/-46					
	54	+/-50	+/-50	+/-50	+/-50	+/-50	+/-50	+/-50	+/-50	+/-50	+/-50	+/-50	+/-50	+/-50	+/-50	+/-50	+/-48.6								
	56	+/-50	+/-50	+/-50	+/-50	+/-50	+/-50	+/-50	+/-50	+/-50	+/-50	+/-50	+/-50	+/-50	+/-50	+/-50									
	58	+/-50	+/-50	+/-50	+/-50	+/-50	+/-50	+/-50	+/-50	+/-50	+/-50	+/-50	+/-50	+/-50											
	60	+/-50	+/-50	+/-50	+/-50	+/-50	+/-50	+/-50	+/-50	+/-50	+/-50	+/-50													
	62	+/-50	+/-50	+/-50	+/-50	+/-50	+/-50	+/-50	+/-50	+/-50															
	64	+/-50	+/-50	+/-50	+/-50	+/-50	+/-50	+/-50	+/-50																
	66	+/-50	+/-50	+/-50	+/-50	+/-50	+/-50																		
	68	+/-50	+/-50	+/-50	+/-50	+/-50																			
	70	+/-50	+/-50	+/-50	+/-50																				
72	+/-50	+/-50	+/-50																						
74	+/-50																								
75.875	+/-50																								

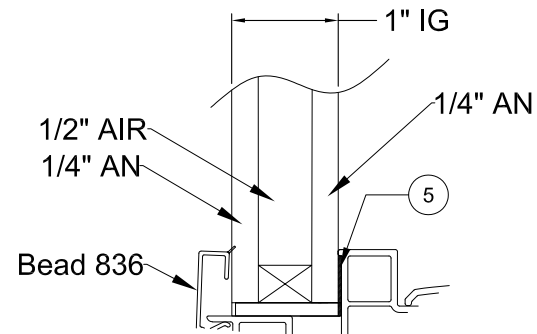

GLASS TYPE 5
1"IG (1/4" A - 1/2" Air - 1/4" A)

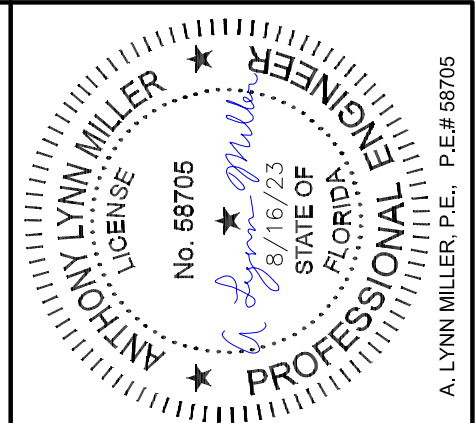

PREPARED BY: A. LYNN MILLER, P.E.
1070 TECHNOLOGY DR
N. VENICE, FL 34275
(941)-480-1600

REGISTRATION #29296
COPYRIGHT © 2022
NEWSOUTH WINDOW SOLUTIONS
LIMITED LICENSE TO MAKE
COPIES FOR PERMITTING

1860 SERIES PICTURE WINDOW
DP TABLES & GLASS TYPES
NEWSOUTH WINDOW SOLUTIONS
10741 CROSSROADS COMMERCE BLVD.
TAMPA, FL 33610

BY:	SB
REVISION:	ADD SILICONE 995
DATE:	08/16/23
#:	A
DATE: 8/12/22	
SCALE: NTS	
BY: S. Berkowitz	
DRAWING #: PW1860-FPA-01	
SHEET: 4 OF 8	

NOTE: 1) FOR SIZES NOT SHOWN, ROUND UP TO THE NEXT AVAILABLE WIDTH OR HEIGHT DIMENSION.

TABLE E:

		Window Design Pressure (psf)																							
		Glass Type 4: 7/8" IG (3/16" T - AIRSPACE - 3/16" T)																							
		Glass Type 6: 1" IG (1/4" T - AIRSPACE - 1/4" T)																							
		Long Side (in.)																							
		75.875	78	80	82	84	86	88	90	92	94	96	98	100	102	104	106	108	110	112	114	116	118	120	
Short Side (in.)	44	+/-50	+/-50	+/-50	+/-50	+/-50	+/-50	+/-50	+/-50	+/-50	+/-50	+/-50	+/-50	+/-50	+/-50	+/-50	+/-50	+/-50	+/-50	+/-50	+/-50	+/-50	+/-50	+/-50	
	46	+/-50	+/-50	+/-50	+/-50	+/-50	+/-50	+/-50	+/-50	+/-50	+/-50	+/-50	+/-50	+/-50	+/-50	+/-50	+/-50	+/-50	+/-50	+/-50	+/-50	+/-50	+/-50	+/-50	+/-50
	48	+/-50	+/-50	+/-50	+/-50	+/-50	+/-50	+/-50	+/-50	+/-50	+/-50	+/-50	+/-50	+/-50	+/-50	+/-50	+/-50	+/-50	+/-50	+/-50	+/-50	+/-50	+/-50	+/-50	+/-50
	50	+/-50	+/-50	+/-50	+/-50	+/-50	+/-50	+/-50	+/-50	+/-50	+/-50	+/-50	+/-50	+/-50	+/-50	+/-50	+/-50	+/-50	+/-50	+/-50	+/-50	+/-50			
	52	+/-50	+/-50	+/-50	+/-50	+/-50	+/-50	+/-50	+/-50	+/-50	+/-50	+/-50	+/-50	+/-50	+/-50	+/-50	+/-50	+/-50	+/-50	+/-50	+/-50				
	54	+/-50	+/-50	+/-50	+/-50	+/-50	+/-50	+/-50	+/-50	+/-50	+/-50	+/-50	+/-50	+/-50	+/-50	+/-50	+/-50	+/-50							
	56	+/-50	+/-50	+/-50	+/-50	+/-50	+/-50	+/-50	+/-50	+/-50	+/-50	+/-50	+/-50	+/-50	+/-50	+/-50									
	58	+/-50	+/-50	+/-50	+/-50	+/-50	+/-50	+/-50	+/-50	+/-50	+/-50	+/-50	+/-50	+/-50											
	60	+/-50	+/-50	+/-50	+/-50	+/-50	+/-50	+/-50	+/-50	+/-50	+/-50	+/-50													
	62	+/-50	+/-50	+/-50	+/-50	+/-50	+/-50	+/-50	+/-50	+/-50															
	64	+/-50	+/-50	+/-50	+/-50	+/-50	+/-50	+/-50	+/-50																
	66	+/-50	+/-50	+/-50	+/-50	+/-50	+/-50																		
	68	+/-50	+/-50	+/-50	+/-50	+/-50																			
	70	+/-50	+/-50	+/-50	+/-50																				
	72	+/-50	+/-50	+/-50																					
	74	+/-50																							
75.875	+/-50																								

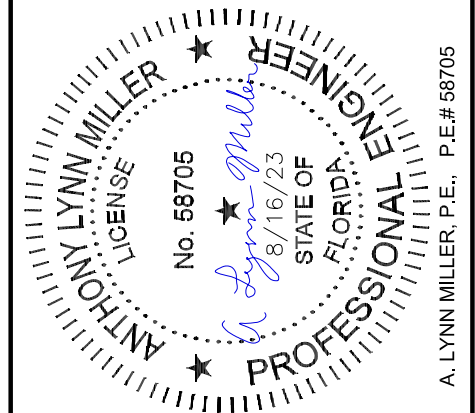
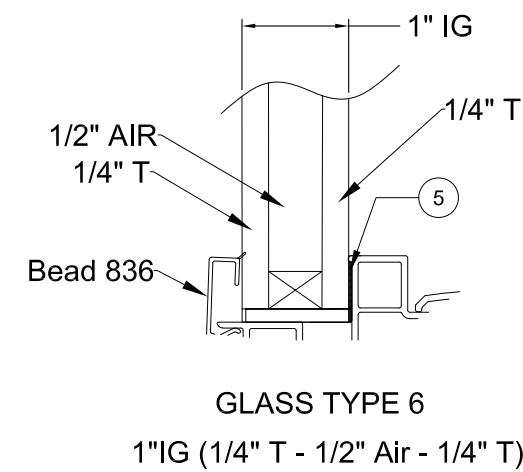
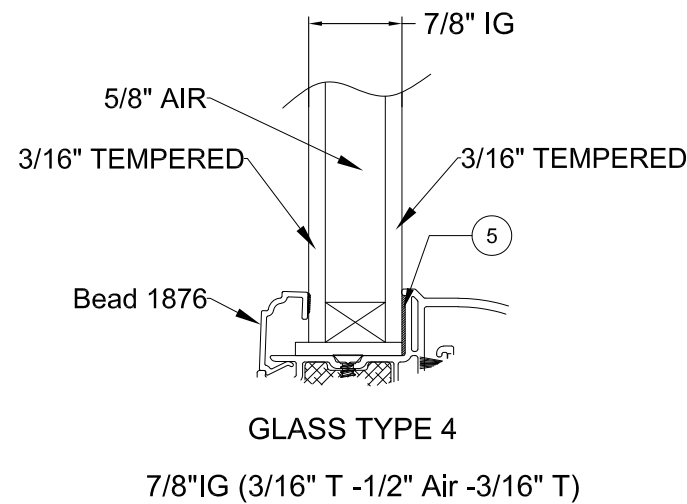

REGISTRATION #29296
COPYRIGHT © 2022
NEWSOUTH WINDOW SOLUTIONS
LIMITED LICENSE TO MAKE
COPIES FOR PERMITTING

PREPARED BY: A. LYNN MILLER, P.E.
1070 TECHNOLOGY DR
N. VENICE, FL 34275
(941)-480-1600

1860 SERIES PICTURE WINDOW
DP TABLES & GLASS TYPES
NEWSOUTH WINDOW SOLUTIONS
10741 CROSSROADS COMMERCE BLVD.
TAMPA, FL 33610

BY: SB

REVISION:	ADD SILICONE 995
DATE:	08/16/23
#:	A
DATE:	8/12/22
SCALE:	NTS
BY:	S. Berkowitz
DRAWING #:	PW1860-FPA-01
SHEET:	5 OF 8

NOTE 1) FOR SIZES NOT SHOWN, ROUND UP TO THE NEXT AVAILABLE WIDTH OR HEIGHT DIMENSION.

1 HEAD EQUAL-LEG FRAME X-SECTION INTO 2X WOOD OR MASONRY

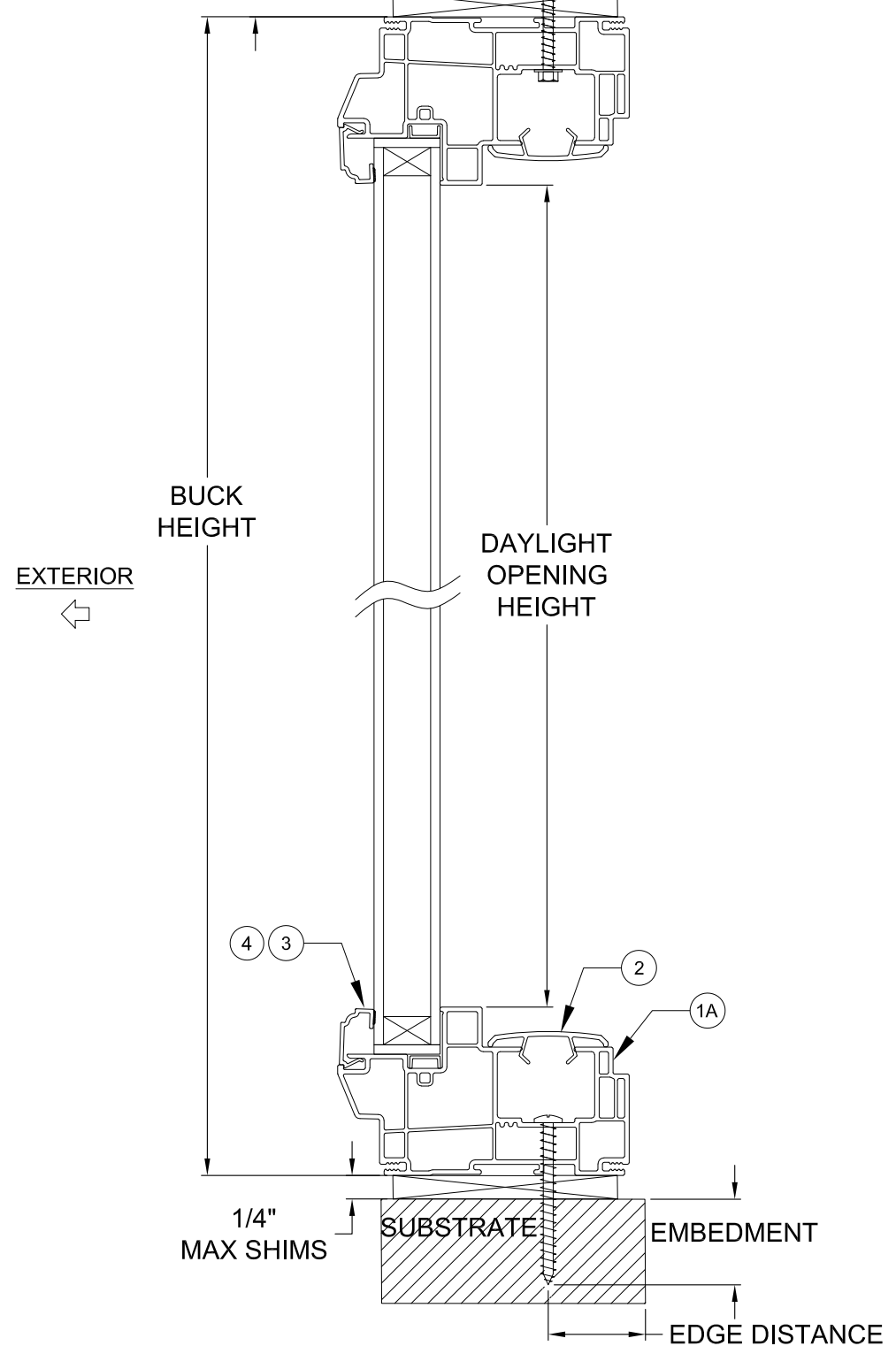
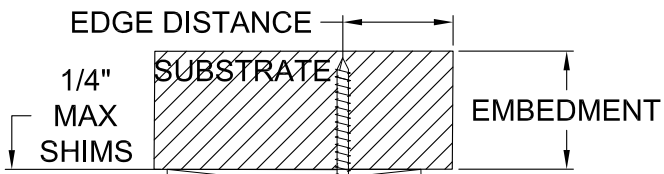

2 SILL EQUAL-LEG FRAME X-SECTION INTO 2X WOOD OR MASONRY

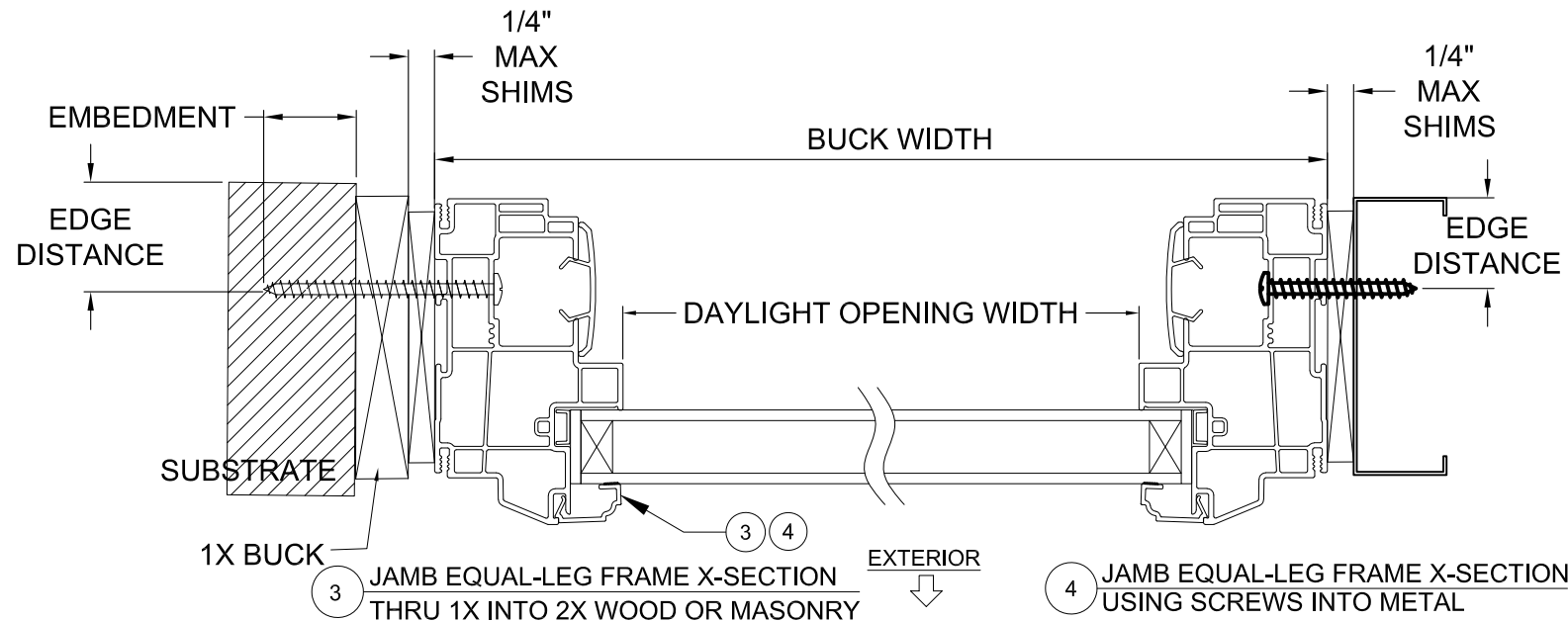

TABLE 1: INSTALLATION ANCHORS

Anchor	Substrate	Min. Edge Distance	Min. O.C. Distance	Min. Embedment
#10 Steel SMS	S. Pine	1/2"	0.756	1-3/8"
	6063-T5	5/16"	0.473	0.045 (18 ga)
	A36 Steel	5/16"	0.567	0.035 (20 ga)
#10 410 SS SMS	A653 Stud, Gr. 33	5/16"	0.567	0.035 (20 ga)
	S. Pine	1/2"	0.756	1-3/8"
	6063-T5	5/16"	0.473	0.045 (18 ga)
3/16" Steel Ultracon+	A36 Steel	5/16"	0.567	0.035 (20 ga)
	A653 stud, Gr. 33	5/16"	0.567	0.035 (20 ga)
	Concrete (2.9 ksi)	1"	3.375	1-3/4"
1/4" Steel Ultracon+	UngROUTED CMU, (ASTM C-90)	1"	3	1-1/4"
	Southern Pine (SG = .55)	1/2"	0.75	1-3/8"
	Concrete (2.9 ksi)	1"	4	1-3/8"
	UngROUTED CMU, (ASTM C-90)	1"	3	1-1/4"
	Southern Pine (SG = .55)	1"	1	1-3/8"

- 1) ANCHOR MUST EXTEND A MINIMUM OF 3 THREADS BEYOND ANY METAL SUBSTRATE.
- 2) "UNGROUTED CMU" VALUES MAY BE USED FOR GROUDED CMU APPLICATIONS.
- 3) ALL ANCHOR HEAD TYPES ARE APPLICABLE.

INSTALLATION NOTES:

- 1) SEE SHEET 1 FOR ANCHOR SPACING REQUIREMENTS.
- 2) ANY INSTALLATION OPTION SHOWN (2X BUCK OR WOOD FRAMING, 1X BUCK, DIRECT TO MASONRY, STEEL STUD) MAY BE USED ON ANY SIDE OF THE WINDOW.
- 3 USE ONLY SUBSTRATE APPROPRIATE ANCHORS LISTED IN ANCHOR TABLE 1. FOLLOW EMBEDMENT AND EDGE DISTANCE LIMITS. MAX. SHIM THICKNESS TO BE 1/4". ANY INSTALLATION OPTION SHOWN MAY BE USED ON ANY OR ALL SIDES OF THE WINDOW.

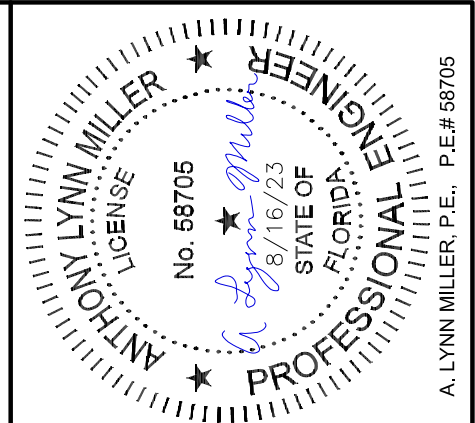

REGISTRATION #29296
 COPYRIGHT © 2022
 NEWSOUTH WINDOW SOLUTIONS
 LIMITED LICENSE TO MAKE
 COPIES FOR PERMITTING

PREPARED BY: A. LYNN MILLER, P.E.
 1070 TECHNOLOGY DR
 N. VENICE, FL 34275
 (941)-480-1600

1860 SERIES PICTURE WINDOW
 EQUAL LEG INSTALLATION
 SECTION VIEWS
 NEWSOUTH WINDOW SOLUTIONS
 10741 CROSSROADS COMMERCE BLVD.
 TAMPA, FL 33610

BY:	SB
REVISION:	ADD SILICONE 995
DATE:	08/16/23
#:	A
DATE:	8/12/22
SCALE:	NTS
BY:	S. Berkowitz
DRAWING #:	PW1860-FPA-01
SHEET:	6 OF 8

1 HEAD INTEGRAL FIN OR FIN/FLANGE FRAME X-SECTION USING NAILS INTO 2X WOOD

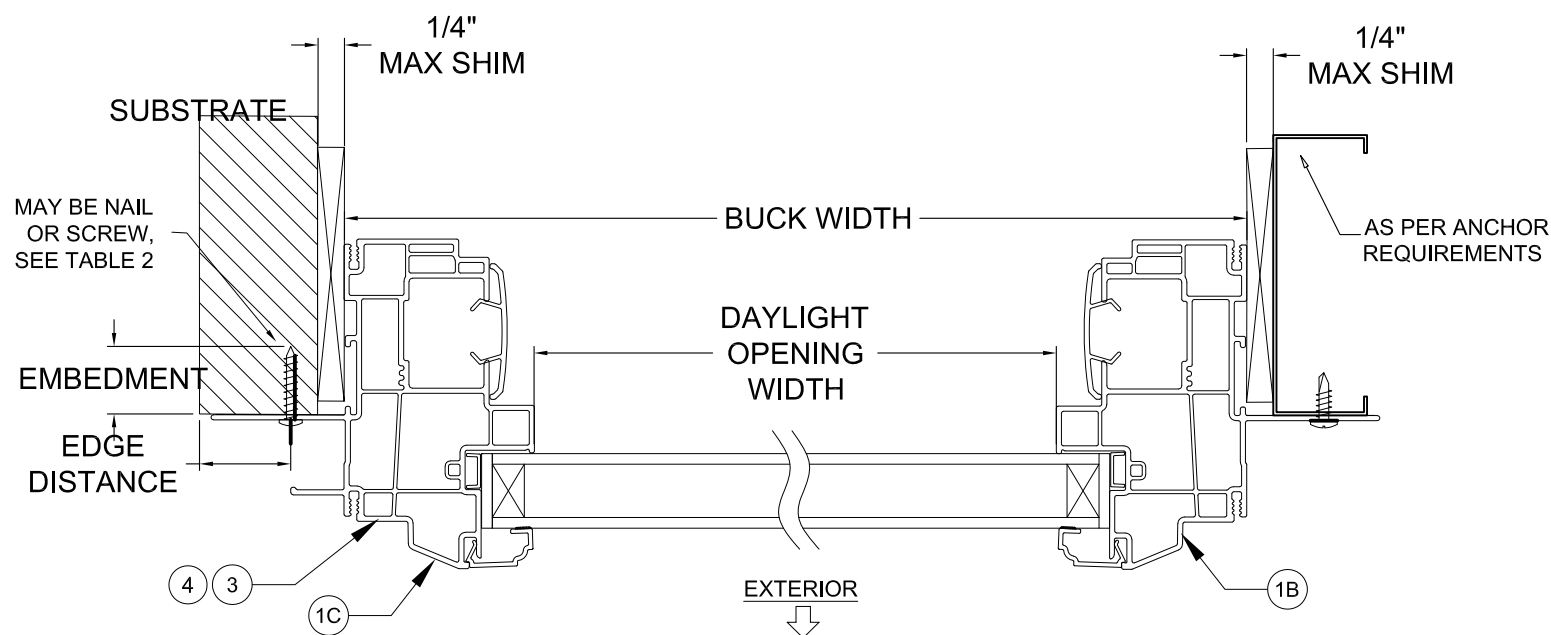
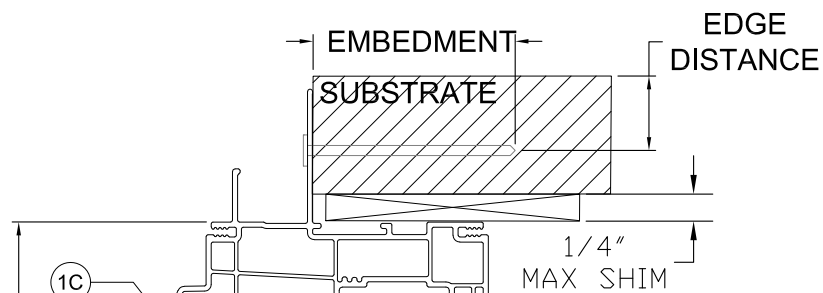

3 JAMB INTEGRAL FIN OR FIN/FLANGE X-SECTION THRU 1X INTO 2X WOOD OR MASONRY

4 JAMB INTEGRAL FIN OR FIN/FLANGE X-SECTION USING SCREW INTO METAL

BUCK HEIGHT
DAYLIGHT OPENING HEIGHT
EXTERIOR

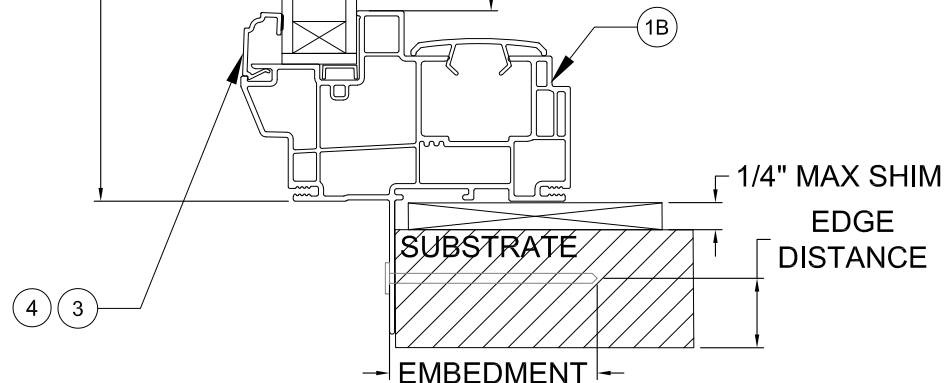

2 SILL INTEGRAL FIN OR FIN/FLANGE FRAME X-SECTION USING NAILS INTO 2X WOOD

TABLE 2: INSTALLATION ANCHORS

Anchor	Substrate	Min. Edge Distance	Min. O.C. Distance	Min. Embedment
2-1/2" x .113" Box Nail	P.T. Southern Pine (SG = .55)	5/16"	0.452	2-7/16"
2-1/2" x .131" Common Nail	P.T. Southern Pine (SG = .55)	5/16"	0.524	2-7/16"
2-1/2" x .145" Roofing Nail	P.T. Southern Pine (SG = .55)	3/8"	0.58	2-7/16"
#10 Steel SMS	P.T. Southern Pine (SG = .55)	1/2"	0.756	1-7/16"
	6063-T5	3/8"	0.473	0.057 (16 ga)
	A36 Steel	5/16"	0.567	0.035 (20 ga)
	Steel Stud Gr. 33	5/16"	0.567	0.035 (20 ga)

1) ANCHOR MUST EXTEND A MINIMUM OF 3 THREADS BEYOND ANY METAL SUBSTRATE.

2) ALL ANCHOR HEAD TYPES ARE APPLICABLE.

INSTALLATION NOTES:

- 1) SEE SHEET 1 FOR SPACING REQUIREMENTS.
- 2) FLANGE AND/OR FIN MAY BE REMOVED TO CREATE OTHER APPROVED FRAME TYPES.
- 3) USE ONLY SUBSTRATE APPROPRIATE ANCHORS LISTED IN ANCHOR TABLE 2. FOLLOW EMBEDMENT AND EDGE DISTANCE LIMITS. ANY INSTALLATION OPTION SHOWN MAY BE USED ON ANY OR ALL SIDES OF THE WINDOW.
- 4) MAX. SHIM THICKNESS TO BE 1/4". MAX. SHIM SPACING TO BE 18".

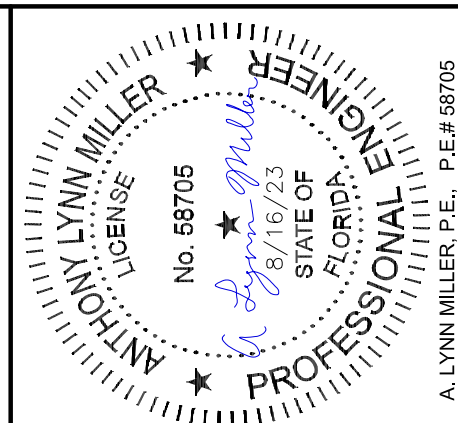

REGISTRATION #29296
COPYRIGHT © 2022
NEWSOUTH WINDOW SOLUTIONS
LIMITED LICENSE TO MAKE
COPIES FOR PERMITTING

PREPARED BY: A. LYNN MILLER, P.E.
1070 TECHNOLOGY DR
N. VENICE, FL 34275
(941)-480-1600

1860 SERIES PICTURE WINDOW
FIN OR FIN/FLANGE INSTALLATION
SECTION VIEWS
NEWSOUTH WINDOW SOLUTIONS
10741 CROSSROADS COMMERCE BLVD.
TAMPA, FL 33610

BY:	SB
REVISION:	ADD SILICONE 995
DATE:	08/16/23
#:	A
DATE:	8/12/22
SCALE:	NTS
BY:	S. Berkowitz
DRAWING #:	PW1860-FPA-01
SHEET:	7 OF 8

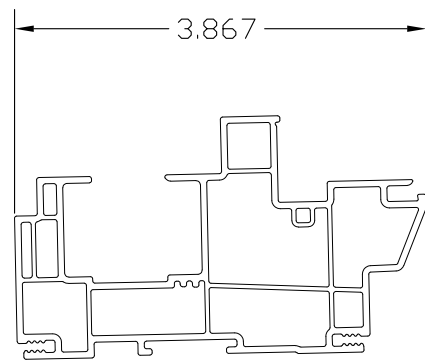

1A 1833A Master Frame Equal-Leg

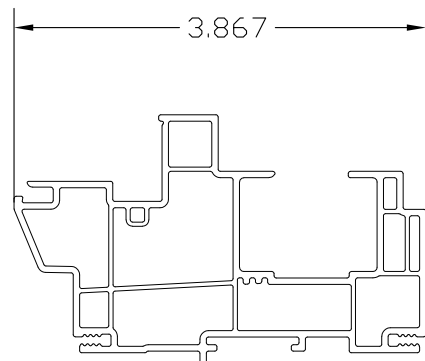

1B 1853J Master Frame Integral Fin

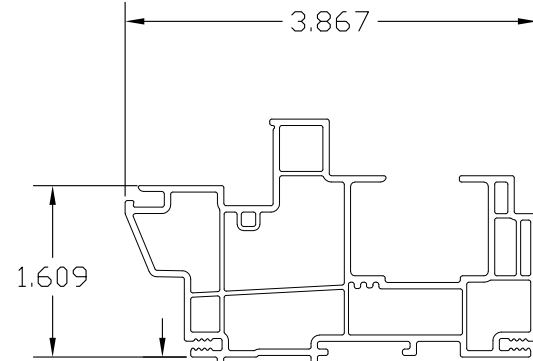

1C 1853A Master Frame Fin/Flange

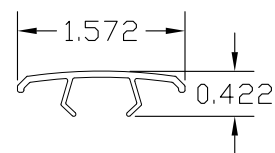

2 1863 Cover

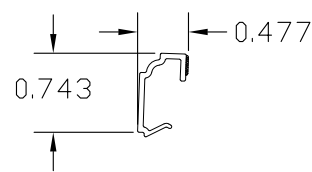

3 1876 Glazing Bead (7/8" Glass)

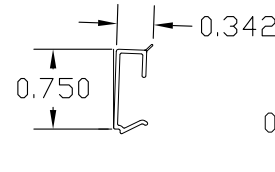

4 836 Glazing Bead (1" Glass)

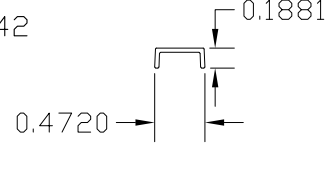

6 440 Glazing Block Filler

TABLE 3: BILL OF MATERIALS

Item	Description	Part #	Material
1A	Master Frame Equal Leg	1833A	Rigid PVC
1B	Master Frame Fin	1853J	Rigid PVC
1C	Master Frame Fin-Flange	1853A	Rigid PVC
2	Cover	1863	Rigid PVC
3	Glazing Bead 7/8" Glass	1876	Rigid PVC
4	Glazing Bead 1" Glass	836	Rigid PVC
5	Glazing compound: RGS 7700, Dow 791, 983, 995	-	
6	Glazing Block Filler	440	Rigid PVC

THE APPROVED, RIGID PVC EXTERIOR EXTRUSIONS ARE TO BE PRODUCED BY EXTRUDERS' LICENSEES UNDER "AAMA CERTIFICATION PROGRAMS FOR RIGID PVC EXTRUSIONS".

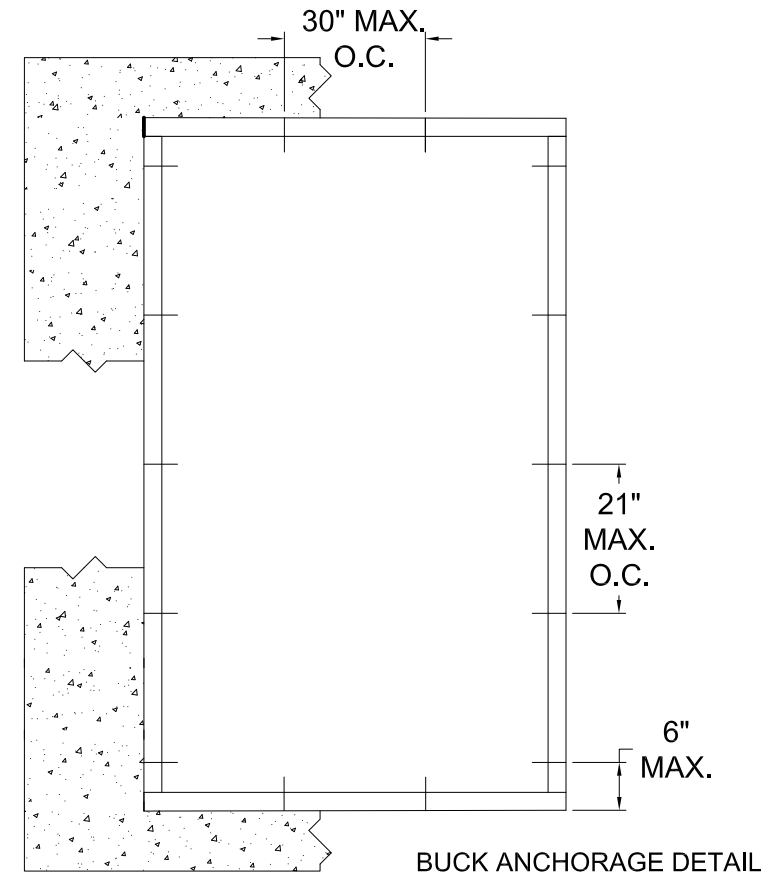

BUCK ANCHORAGE DETAIL

TABLE 4

Anchor	Substrate	Minimum Edge Distance	Minimum Embedment
1/4" Steel Ultracon+	Concrete (min. 3.0 ksi)	1"	1-3/8"
	UngROUTED CMU, (ASTM C-90)	1"	1-1/4"

1) "UNGROUTED CMU" VALUES MAY BE USED FOR GROUTED CMU APPLICATIONS.

2) ALL ANCHOR HEAD TYPES ARE APPLICABLE.

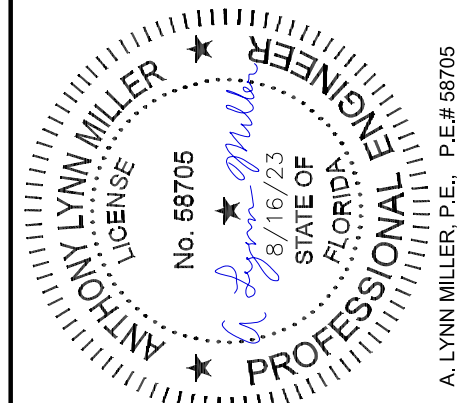

A. LYNN MILLER, P.E., P.E.# 58705

REGISTRATION #29296
 COPYRIGHT © 2022
 NEWSOUTH WINDOW SOLUTIONS
 LIMITED LICENSE TO MAKE
 COPIES FOR PERMITTING

PREPARED BY: A. LYNN MILLER, P.E.
 1070 TECHNOLOGY DR
 N. VENICE, FL 34275
 (941)-480-1600

1860 SERIES PICTURE WINDOW
 BILL OF MATERIALS, EXTRUSIONS, &
 BUCK INSTALLATION DETAILS
 NEWSOUTH WINDOW SOLUTIONS
 10741 CROSSROADS COMMERCE BLVD.
 TAMPA, FL 33610

REVISION:	BY:	DATE:	#:
	SB	08/16/23	A

DATE: 8/12/22
 SCALE: NTS
 BY: S. Berkowitz
 DRAWING #: PW1860-FPA-01
 SHEET: 8 OF 8